

DAMPA®

Silent Board

Installation guide

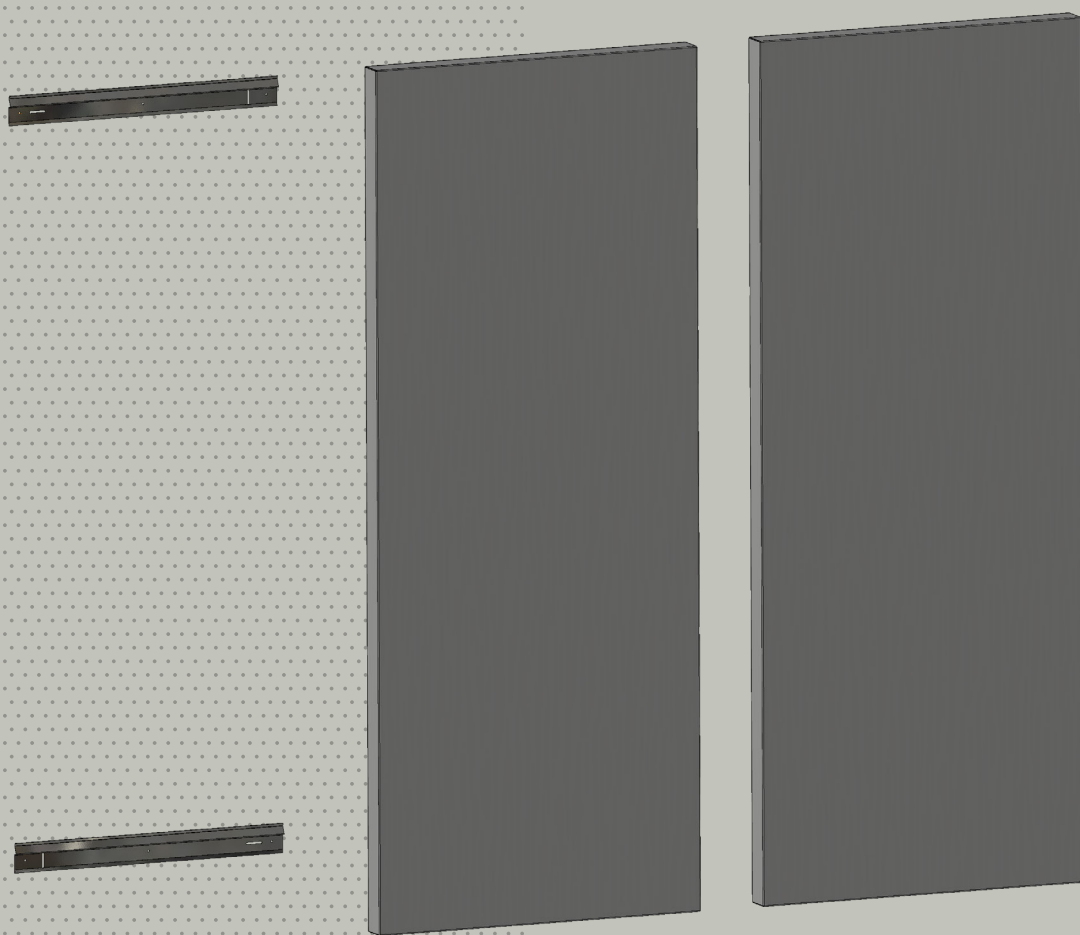

DAMPA®

Installation of DAMPA® Silent Board

DAMPA® Silent Board can easily be installed with a few components.

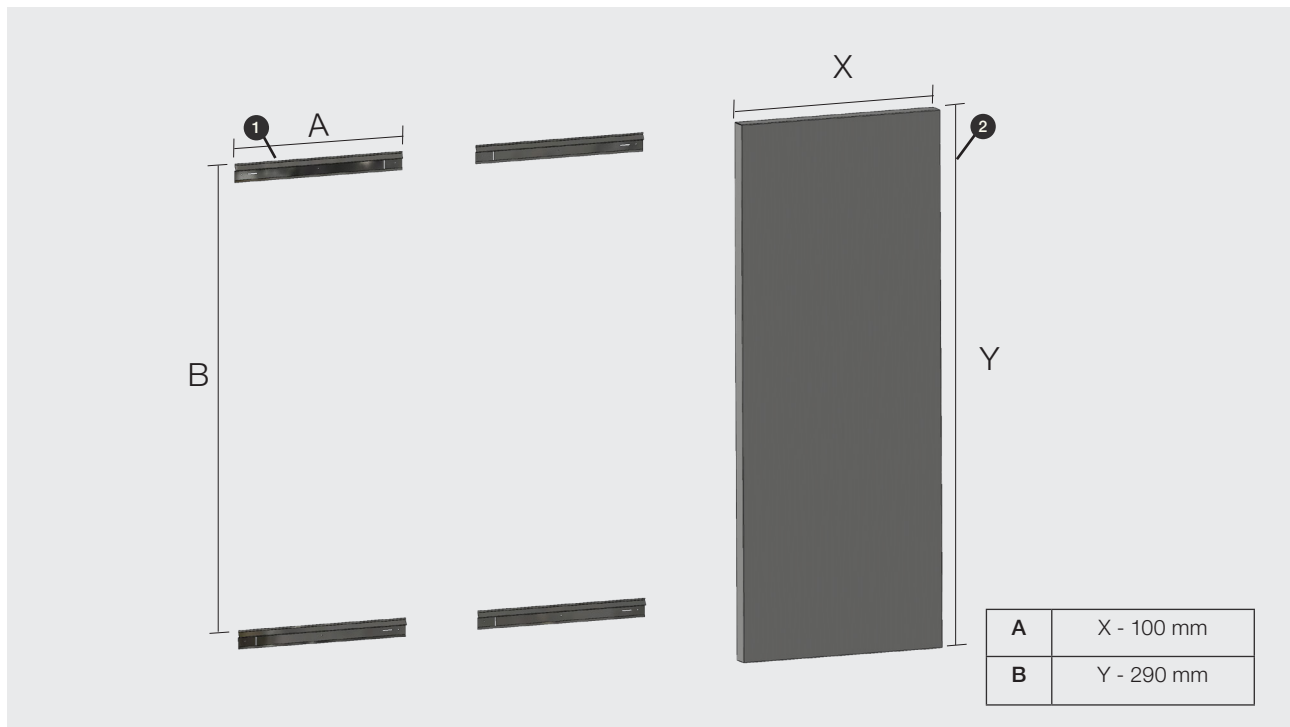

1



Wall carrier

Size: 47 x 500 or 2000 mm
Material: Galvanized steel

2

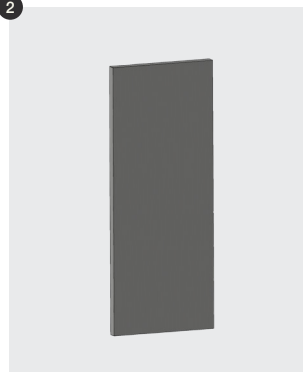

Wall panel

Size (W x H x D):
600 x 1200 x 50 mm
600 x 1500 x 50 mm
600 x 1800 x 50 mm
600 x 1200 x 100 mm
600 x 1500 x 100 mm
600 x 1800 x 100 mm

Material: Steel

1

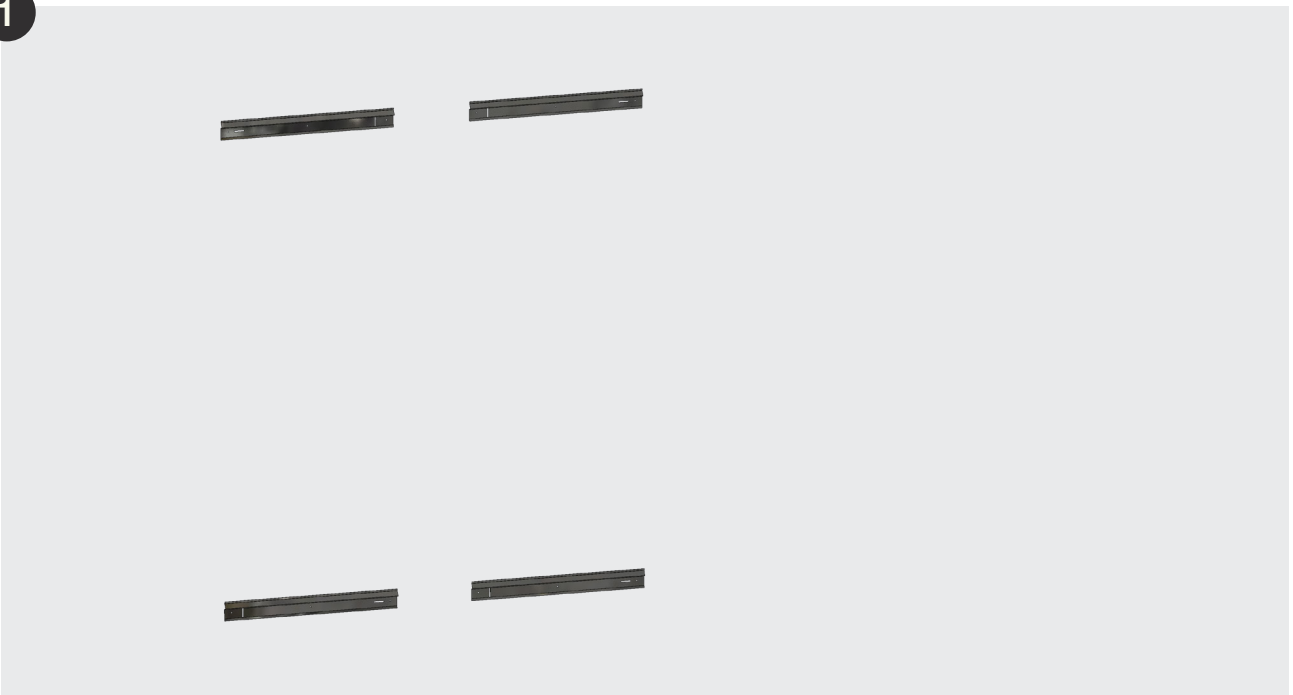

The top wall carrier is initially installed by positioning it so that its upper edge aligns with the desired height of the wall panel. The wall carrier is mounted level on the wall using flat-head screws.

Next, the bottom wall carrier is installed. The distance between the carriers depends on the height of your wall panel, as illustrated on the previous page.

2

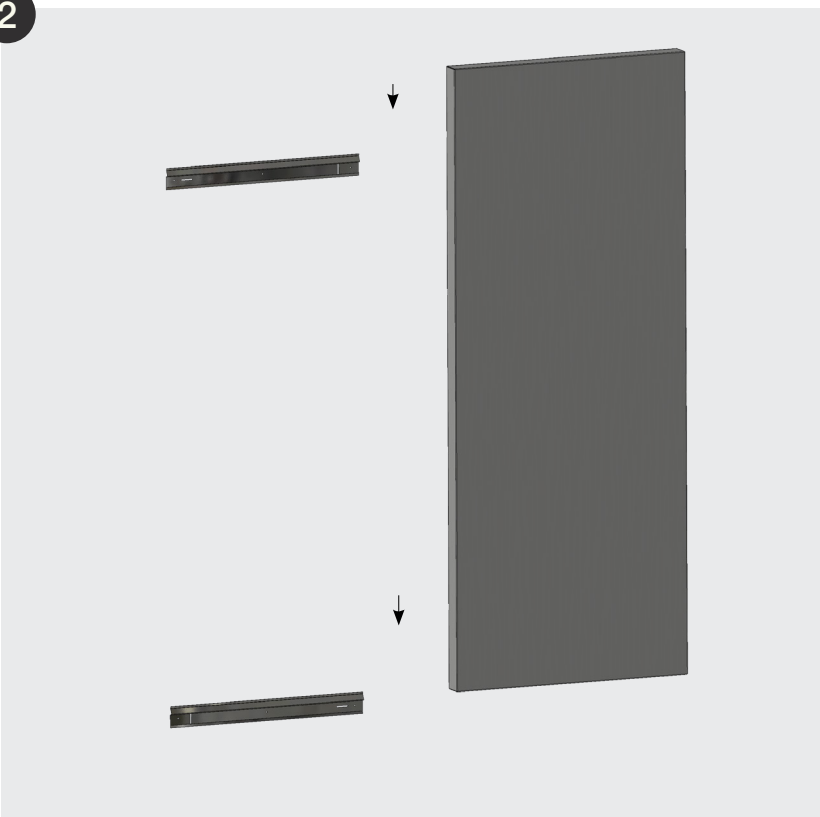

The DAMPA® Silent Board panels are installed by lowering the upper edge of the panel, along with the crossing rail on the back, onto the wall carriers.

Ensure that the wall panel is held flush against the wall at both the top and bottom during installation.

2a

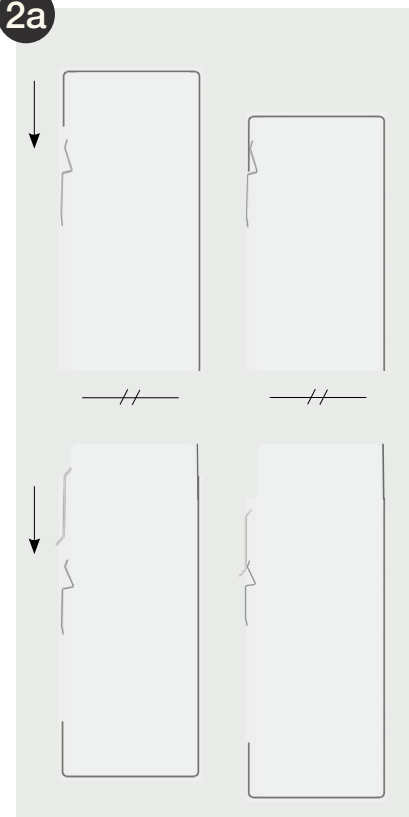

When correctly mounted, the wall panel cannot be pulled out from the wall.

DAMPA® Silent Board Components



Wall carrier

Size: 47 x 500 or 2000 mm
Material: Galvanized steel

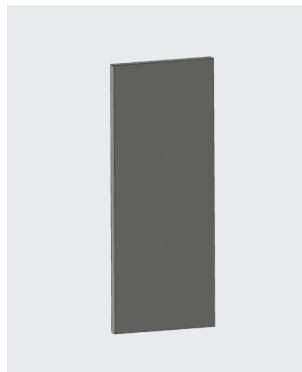

Wall panel

Size (W x H x D):
600 x 1200 x 50 mm
600 x 1500 x 50 mm
600 x 1800 x 50 mm
600 x 1200 x 100 mm
600 x 1500 x 100 mm
600 x 1800 x 100 mm

Material: Steel

DAMPA®

DK-5690 Tommerup, Tel.: +45 63 76 13 00
dampa@dampa.dk, www.dampa.com