

DAMPA® Clip-In Tile Installation Guide

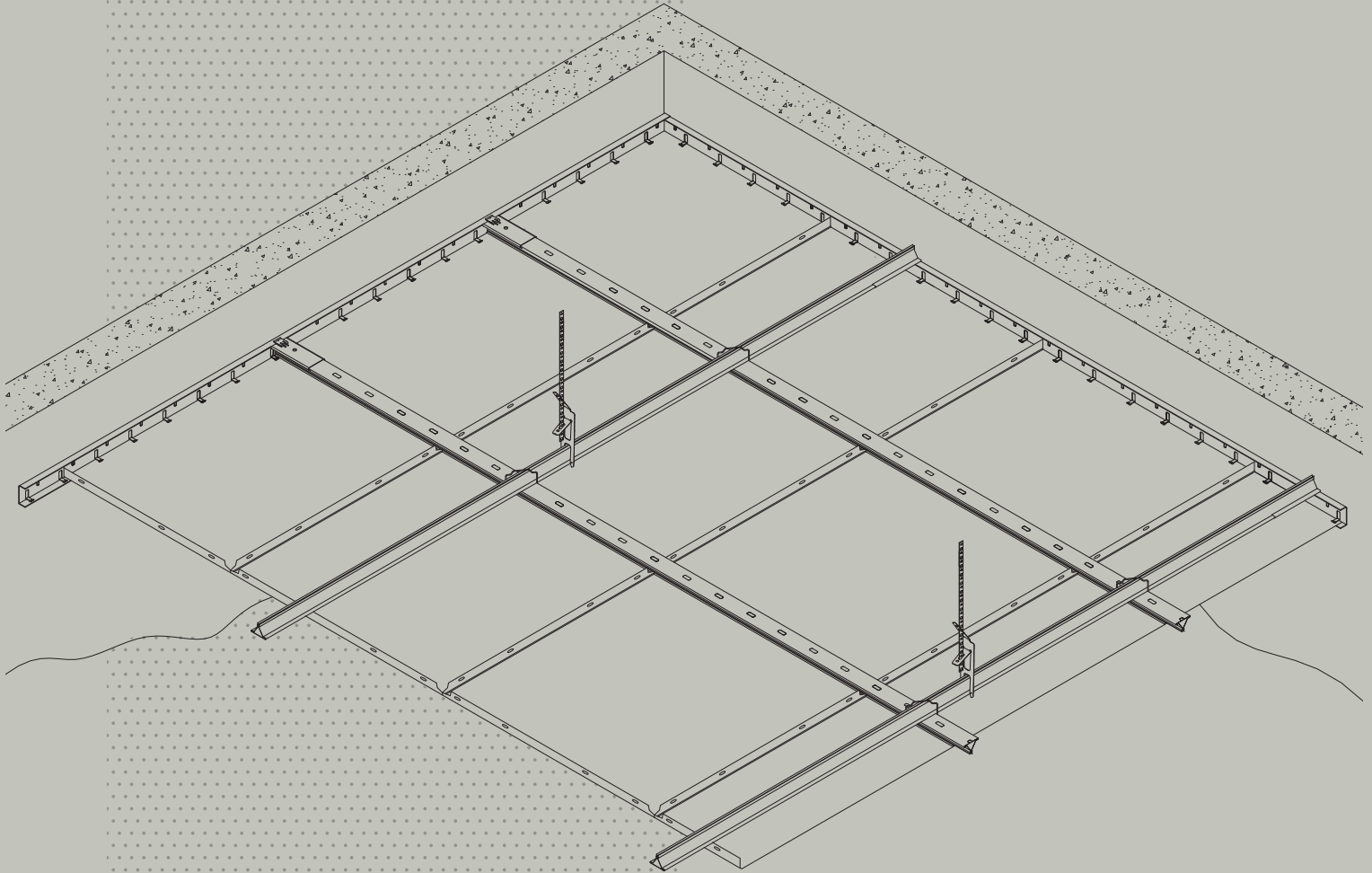

DAMPA®

Installation of DAMPA® Clip-In Tile

The installation of DAMPA® Clip-In Tiles, with or without bevelled edge, in a concealed suspension system creates a flat and uniform ceiling surface.

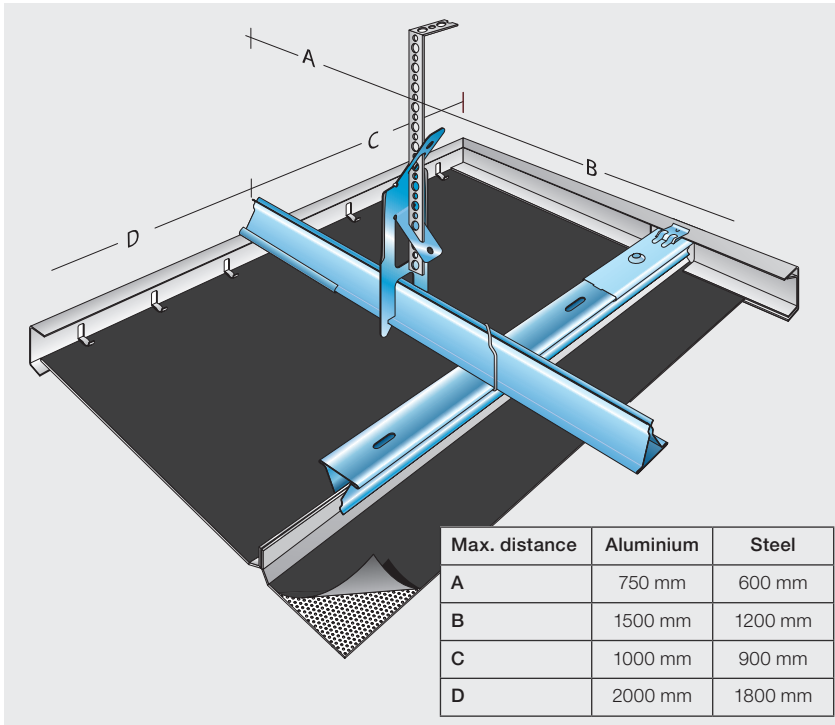

The tiles are secured to the carriers – without the use of tools. If necessary, it is possible to remove and reinstate individual tiles by means of a simple dismantling tool.

The suspension system is not related to specific modules and creative combinations are possible using different tile sizes.

Installation

A primary grid system is recommended to maintain maximum rigidity of the ceiling construction. This will also minimise the number of hangers and provide for greater flexibility during installation.

After installation of the edge trims, the primary grid upper carriers are installed and the lower carriers are secured to the upper ones using coupling clips. Perimeter cut tiles should be larger than half a tile.

It may be necessary to provide additional support in close proximity to other integrated components, e.g. lighting and ventilation, to avoid excessive ceiling deflection.

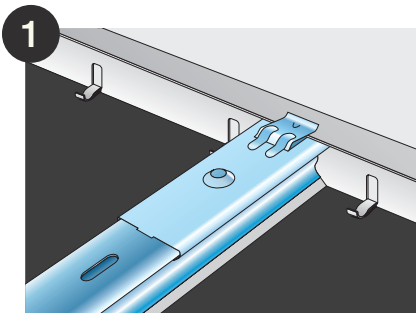

Edge Trim No. 11 is used to secure cut aluminium perimeter tiles. Carrier Splice No. 4 is secured to the top flange of the lower carrier. It also locates on the top flange of the edge trim to maintain the correct tile height.

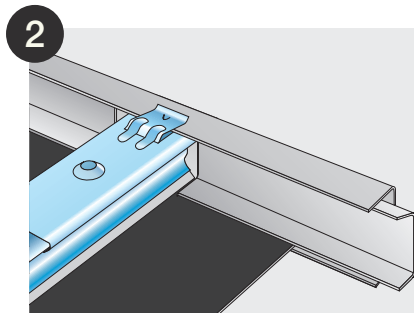

Cut steel perimeter tiles are supported using Edge Trim No. 36 and held in position with Wedge No. 4 as shown above. Alternatively, Shadow Gap Edge Trim No. 6 - held in position with Wedge No. 5 - can be used.

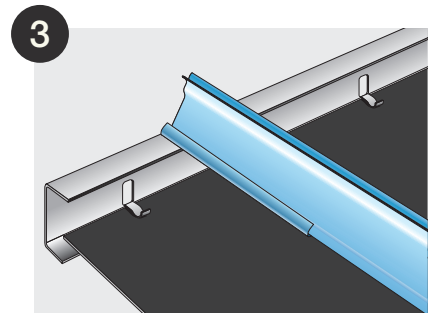

Carrier Splice No. 4 is also used to maintain the correct height of the primary grid upper carriers.

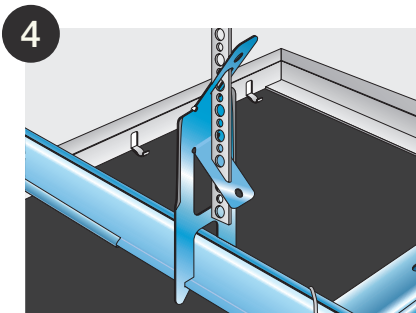

Adjustment Clip No. 4 can be secured to the primary or secondary carrier. The hanger is fastened to the soffit allowing a pull-out force of at least 2.5 times the hanger load.

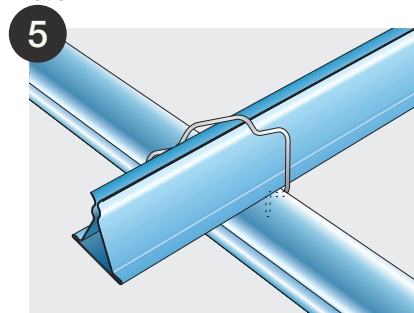

Coupling Clip No. 1 is used to connect the primary and secondary grid carriers.

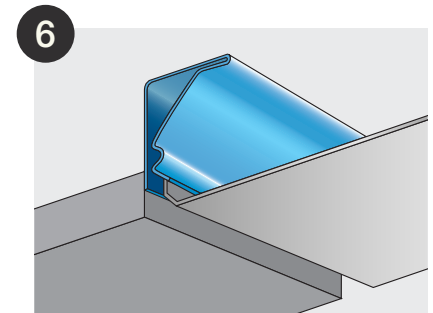

Carrier No. 10 is used as a perimeter detail to support full tiles.

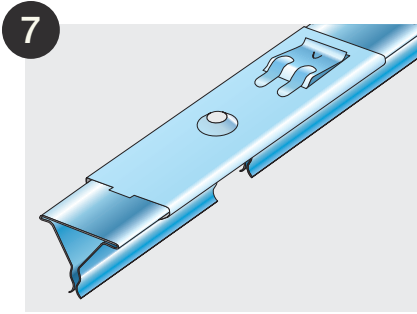

Carrier Splice No. 4 is centrally positioned over the joints in the carriers. The hanger distance from the joints must not exceed 500 mm. A gap of 2-4 mm should be maintained to allow for expansion.

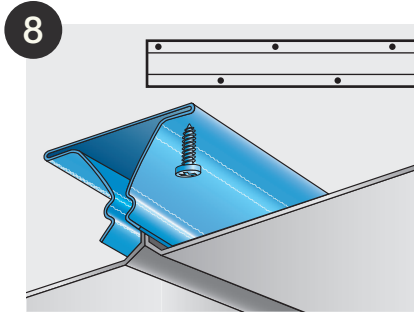

By direct installation Carrier No. 4 is fastened on alternative sides with suitable screws directly to the soffit and thus only Edge Trim No. 11 can be used.

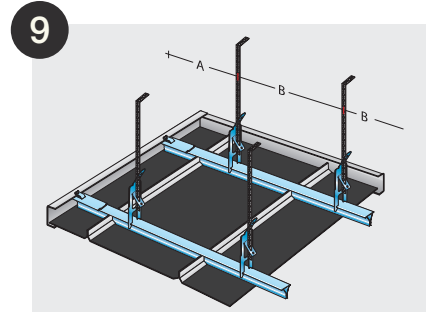

The single system can also be used. It consists of parallel carriers. Each carrier is supported by hangers.

Max. distance	Aluminium	Steel
A	1000 mm	900 mm
B	2000 mm	1800 mm

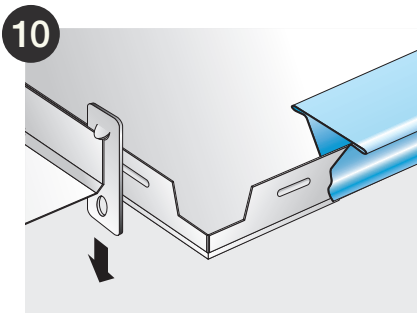

It is possible to remove and reinstate individual tiles anywhere in the ceiling.

See demounting guide on page 4.

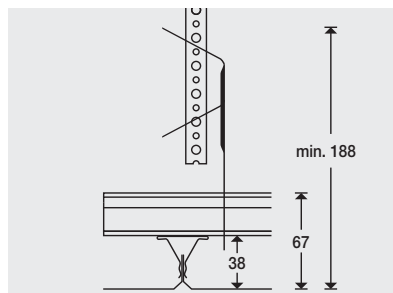

Construction height

The suspended DAMPA Clip-In Tiles have a minimum constructional height of 188 mm. The minimum constructional height of DAMPA Clip-In Tiles installed direct to the soffit is 38 mm.

Floating Ceiling Areas

As perimeter solution Carrier No. 10 is used for full tiles, whereas Edge Trim No. 11 is used for cut tiles. In the primary grid system both upper and lower carriers are secured by means of screws or pop rivets to the edge solution.

To secure stability the maximum distance from the edge solution to the upper carrier must not exceed 200 mm.

Modules

DAMPA Clip-In / Aluminium

Module 300 × 600 mm, material thickness 0.7 mm
 Module 600 × 600 mm, material thickness 0.7 mm
 Module 625 × 625 mm, material thickness 0.7 mm

Product	Average Consumption	Packing
Carrier No. 4	2.00 m/sq. m	10 units/bundle
Carrier No. 10	1.00 m/sq. m	10 units/bundle
Carrier Splice No. 4	1.20 unit/sq. m	250 units/box
Coupling Clip No. 1	1.00 unit/sq. m	200 units/box
Adjustment Clip No. 4	0.50 unit/sq. m	250 units/box
Hanger No. 5 (suspended 500 mm)	0.25 m/sq. m	100 m/coil
Edge Trim No. 11	1.00 m/sq. m	10 units/bundle

Module 300 × 300 mm, material thickness 0.7 mm

Product	Average Consumption	Packing
Carrier No. 4	4.00 m/sq. m	10 units/bundle
Carrier Splice No. 4	2.20 unit/sq. m	250 units/box
Coupling Clip No. 1	2.00 unit/sq. m	200 units/box
Adjustment Clip No. 4	0.50 unit/sq. m	250 units/box
Hanger No. 5 (suspended 500 mm)	0.25 m/sq. m	100 m/coil
Edge Trim No. 11	1.00 m/sq. m	10 units/bundle

DAMPA Clip-In / Steel

Module 300 × 600 mm, material thickness 0.5 mm
 Module 600 × 600 mm, material thickness 0.5 mm
 Module 312,5 × 625 mm, material thickness 0.5 mm
 Module 625 × 625 mm, material thickness 0.5 mm

Product	Average Consumption	Packing
Carrier No. 4	2.25 m/sq. m	10 units/bundle
Carrier Splice No. 4	1.60 unit/sq. m	250 units/box
Coupling Clip No. 1	1.10 unit/sq. m	200 units/box
Adjustment Clip No. 4	0.60 unit/sq. m	250 units/box
Hanger No. 5 (suspended 500 mm)	0.30 m/sq. m	100 m/coil
Edge Trim No. nr. 36 / Shadow Gap Edge Trim No. 6	1.00 m/sq. m	10 units/bundle
Wedge No. 4 / No. 5	2.85 m/sq. m	200 units/box

Module 300 × 300 mm, material thickness 0.5 mm

Product	Average Consumption	Packing
Carrier No. 4	4.25 m/sq. m	10 units/bundle
Carrier Splice No. 4	2.30 unit/sq. m	250 units/box
Coupling Clip No. 1	2.10 unit/sq. m	200 units/box
Adjustment Clip No. 4	0.60 unit/sq. m	250 units/box
Hanger No. 5 (suspended 500 mm)	0.30 m/sq. m	100 m/coil
Edge Trim No. 36 / Shadow Gap Edge Trim No. 6	1.00 m/sq. m	10 units/bundle
Wedge No. 4 / No. 5	2.85 m/sq. m	200 units/box

Demounting of DAMPA® Clip-In Tiles

When demounting DAMPA® Clip-In and DAMPA® Clip-In Custom Tile, use DAMPA's specially designed demounting tool, as shown on the right.

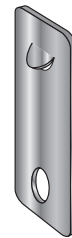

To avoid damage to the ceiling elements, do not use screwdrivers or other tools to remove the tiles. Additionally, the removal of ceiling tiles over 1200 mm should be done by two people.

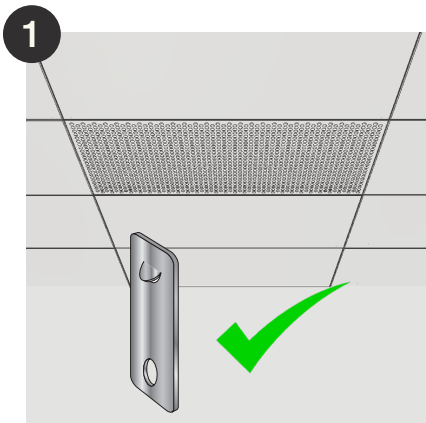

When removing DAMPA® Clip-In and DAMPA® Clip-In Custom tiles, use DAMPA's demounting tool.

The demounting tool can be ordered for free from DAMPA's customer service.

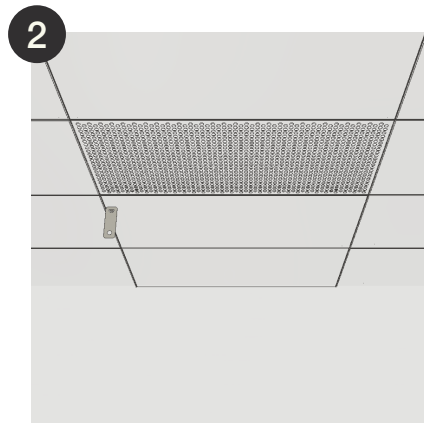

To remove a single tile, insert the demounting tool between two ceiling tiles near the carrier.

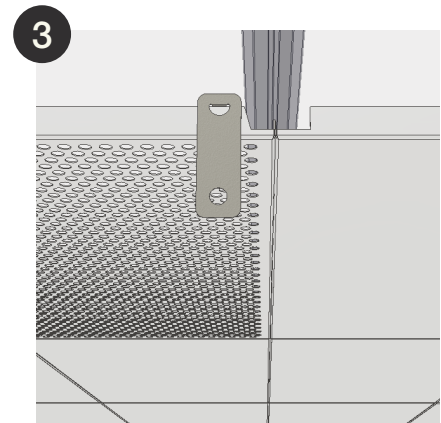

Place the demounting tool over the edge of the tile and release the corner of the tile from the carrier by gently pulling the demounting tool downwards.

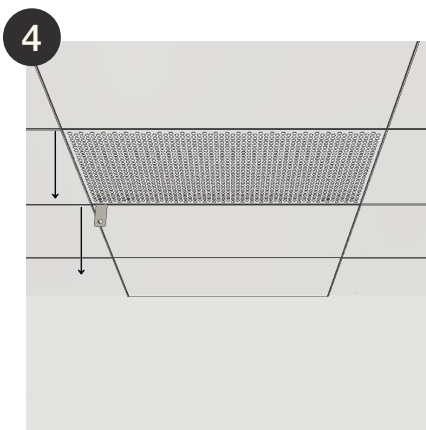

By repeating step 3, gently release the ceiling tile at two corners in opposite carriers.

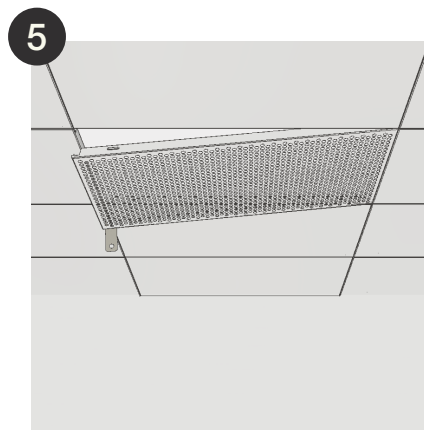

Next, pull the tile down at the two corners in opposite carriers, and then carefully slide it out of the carriers by gently opening it in the lengthwise direction.

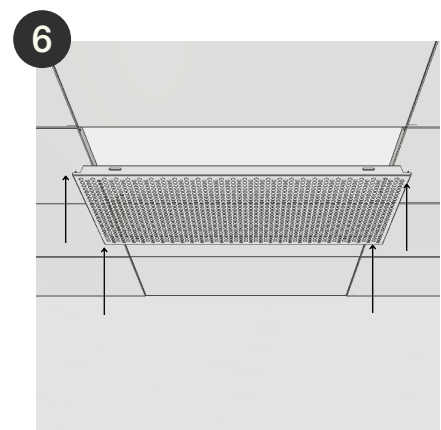

To reinstall the tile, gently push it back into the carriers by pressing the tile up into the carriers at the location of the embossments.

DAMPA® Clip-In Tile Components

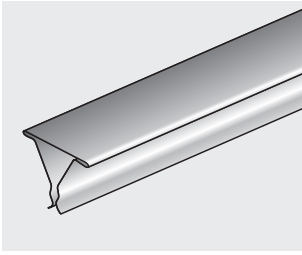

Carrier No. 4
Size: 29 × 35 × 4000 mm
Material: Galvanised steel

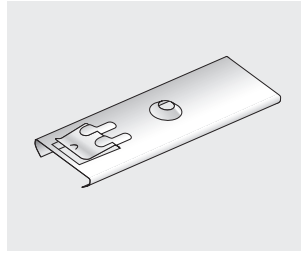

Carrier Splice No. 4
Size: 12 × 40 × 110 mm
Material: Galvanised steel

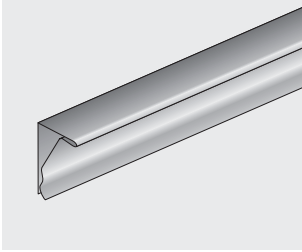

Carrier No. 10
Size: 33 × 18 × 4000 mm
Material: Galvanised steel
Finish: Painted

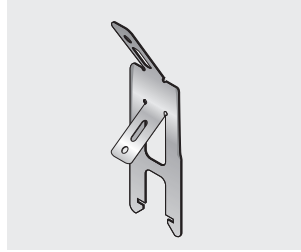

Adjustment Clip No. 4
Size: 38 × 50 × 160 mm
Material: Spring steel

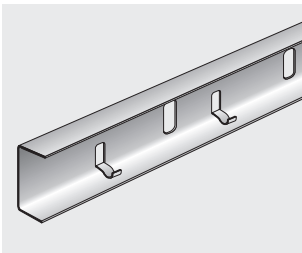

Edge Trim No. 11
Size: 15 × 38 × 15 × 4000 mm
Material: Galvanised steel
Finish: Painted

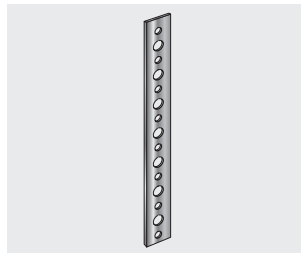

Hanger No. 5
Size: 1 × 14 mm
Length: 100 m
Material: Galvanised steel

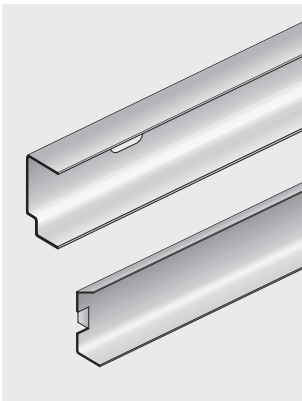

Shadow Gap Edge Trim No. 6
Can be delivered concave or convex
Size: 20 × 38 × 14 × 4000 mm
Skygge: 6 × 9 mm
Material: Galvanised steel
Finish: Painted

Wedge No. 4
Size: 36 × 15 × 274 mm
Material: Galvanised steel

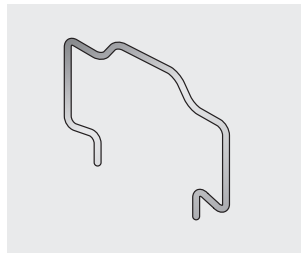

Coupling Clip No. 1
Size: 40 × 53 mm
Material: 2 mm galvanised spring steel

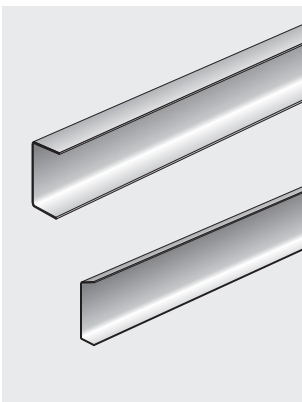

Edge Trim No. 36
Can be delivered concave or convex
Size: 15 × 38 × 15 × 4000 mm
Material: Galvanised steel
Finish: Painted

Wedge No. 5
Size: 37 × 15 × 274 mm
Material: Galvanised steel



Dismantling Tool
Size: 75 × 25 mm
Material: 0.3 mm spring steel

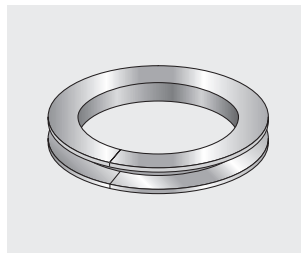

Pillar Ring
Can be delivered concave or convex

Edge Trim No. 36
Size: 15 × 16 × 15 mm
Diameter: Min. 330 mm

Shadow Gap Edge Trim No. 6
Size: 15 × 16 × 15 mm
Diameter: Min. 900 mm
Material: Steel
Finish: Painted

We reserve the right to alter described material without prior notification